

2021

ULTRAMax[®]
ALUMINUM RAILING SYSTEMS

A safe, low-maintenance
Ultra lifestyle now comes in a kit

Ultra Max[®] Ready-to-Build Railing Systems

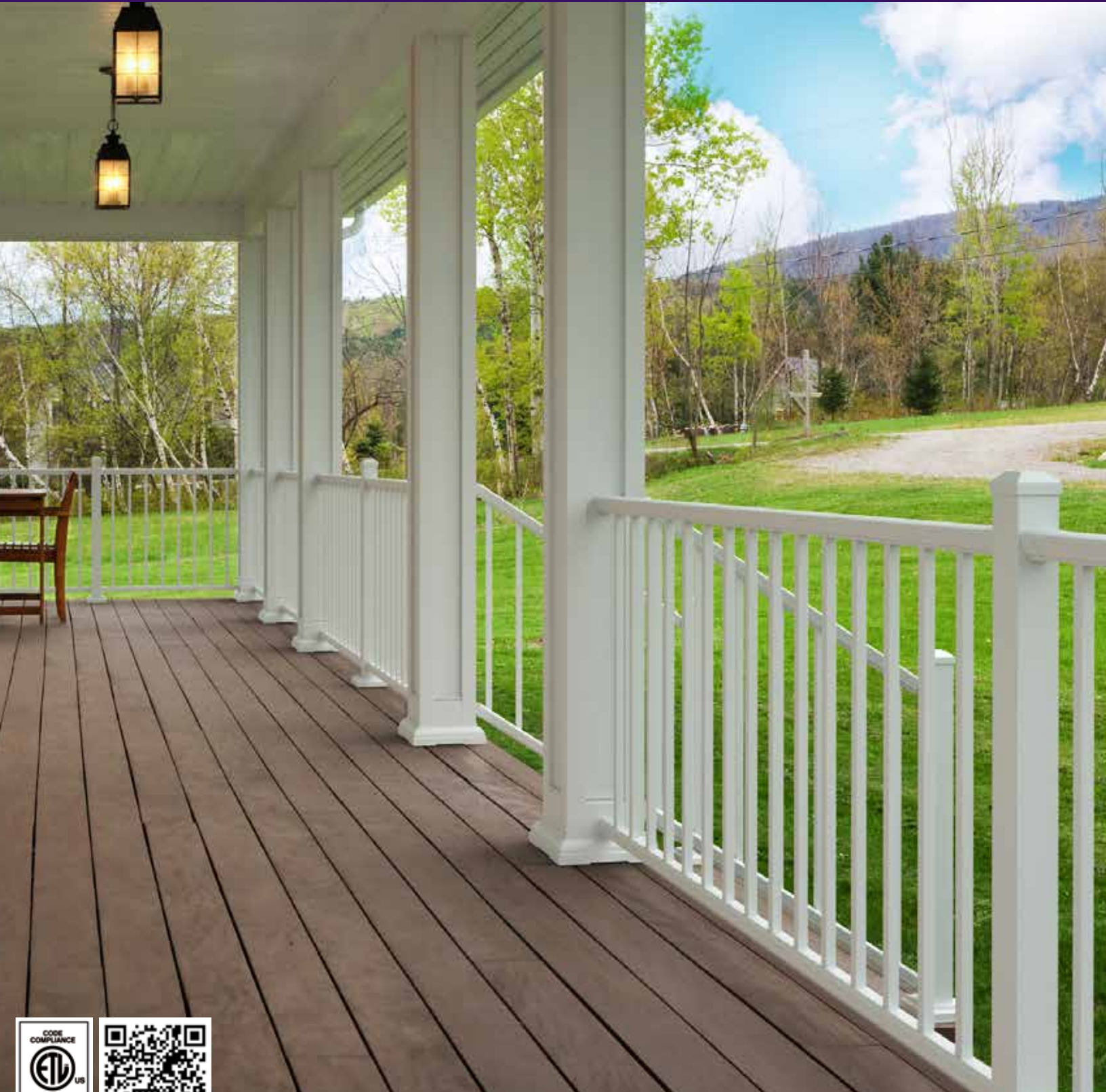

CCRR Code Approved #0278

Ultra Max® Railing in 2-rail configuration in Textured Khaki



YouTube INSTALLATION VIDEOS

Subscribe to our YouTube Channel and check out our installation videos at www.youtube.com/channel/UCrbawEKcb24neS8UyXj5nfg

Level Railing Kits



Stair Kits



Post Kits



XacTemplate™



Our easy-to-build railing kits provide safety and high quality at a more reasonable price.



The Intertek Evaluation Process Mark means that Ultra Max™ railing components are tested and conform to IRC-IBC building codes. It also ensures the ongoing verification of compliance—with quarterly reviews and inspections.

Ultra Max® Railing is the perfect addition to your porches, decks or walkways.

Ultra Max® offers an elegant handrail profile, with a classic baluster configuration, and four different textured colors. They all come together to form a custom look and feel that will work well with your home and landscaping design.

Ultra Max® Railing in 2-rail configuration in two-toned Textured Khaki Posts and Rails with Textured Bronze balusters



ULTRAmax[®]

ALUMINUM RAILING SYSTEMS

Simple

Simple installation is the key design element to the new Ultra Max[®] Railing Systems. Our XacTemplate[™] Installation Guide locates bracket placement quickly on every post. Simply screw brackets into place and drop your railing into the brackets.



Durable

Our exclusive Powercoat[™] finish is twice the thickness and hardness of a typical baked enamel finish, and is guaranteed for life against cracking, peeling or chipping. It meets AAMA 2604 standards for the ultimate in durability and UV protection.



Versatile

A variety of customization options are available to create a deck that's truly unique including Deck-Over-Rail for a convenient drink ledge. Mix and match colors and a variety of balusters for a personalized design. Column wraps are also offered to easily attach around wood porch posts or understructure to complement the look of your railing project.



Illumination

Firefly[™] Illumination by Ultra Aluminum[™] will add ambiance and provide additional hours of outdoor living. This easy to install system runs post to post and in-rail lights connect to each other in a "Daisy Chain". Firefly offers a variety of low voltage illumination options that will light up a dark porch or deck.



Strong

Our U-X-TRUSION from Ultrum[™] 6005-T5 alloy tests at a minimum ultimate strength of 35,000 psi. High-strength aluminum lasts longer and wears better than wood. Aluminum saves time and money on costly maintenance. Tested by Intertek.





Fast-Track 2-Piece Bracket and Baluster Installation

Ease of installation, combined with the strength of our aluminum construction, are the key features in the new Ultra Max® Railing Systems. The Ultra Max® Connector System allows for quick installation of balusters without any screws or spacers. It guides balusters in place and eliminates rattling noise.

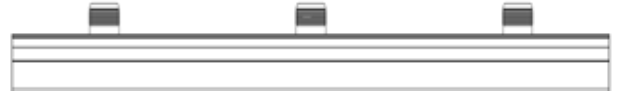

Ultra Max® Connector System



Square



37" and 43" Square Baluster 2-Rail Level Railing Kits

All railing kits feature the Adams Profile and include:

Top and Bottom Rails, Balusters, Brackets and Fasteners

4 ft. kit sections are 48.25" wide (with 10 balusters); 6 ft. kit sections are 70.5" wide (with 15 balusters); 8 ft. kits are 97.25" wide (with 21 balusters), with brackets and 2" sweep

A Third Rail Kit (UAR-200 3R) is available by special order.

37" Square Baluster 2-Rail Railing Kits

MODEL NUMBER

UMX-A200__-3648-2RLS

UMX-A200__-3672-2RLS

UMX-A200__-3696-2RLS

DESCRIPTION

36" x 48" - 2 Rail Level Square Kit

36" x 72" - 2 Rail Level Square Kit

36" x 96" - 2 Rail Level Square Kit

43" Square Baluster 2-Rail Railing Kits

MODEL NUMBER

UMX-A200__-4248-2RLS

UMX-A200__-4272-2RLS

UMX-A200__-4296-2RLS

DESCRIPTION

42" x 48" - 2 Rail Level Square Kit

42" x 72" - 2 Rail Level Square Kit

42" x 96" - 2 Rail Level Square Kit

Enter Color Code when ordering: **Black: TB / Bronze: TZ / Khaki: TK / White: TW**

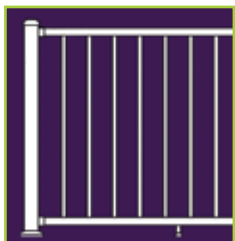

UMX-200 2R Two Rail

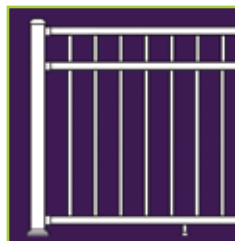

UMX-200 3R Three Rail

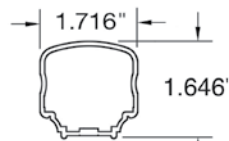

Top Rail

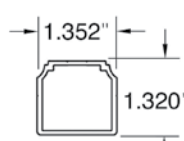

Bottom Rail

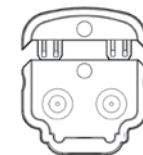

Top Bracket

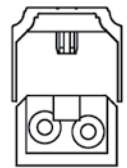

Bottom Bracket

Bracket Kits Enter Color Code when ordering: **Black: TB / Bronze: TZ / Khaki: TK / White: TW**

MODEL NUMBER

UMX-KAL-2P111-__

UAR-KAV-111S-__

UAR-KAH-111H-__

UAR-FBK01-__

UMX-IGT-ATB

DESCRIPTION

Level Bracket Pack

Stair Vertical Rail End Pack

Horizontal Rail End Pack

Footblock Kit

Install Guide Template Kit

ADDITIONAL

4 brackets w/screws & foot-block

4 brackets w/screws

4 brackets w/screws

3/4" baluster 2" with screws & shoe

One T-30 Bit



3-Rail Add-On Kits

To create a 3-Rail configuration for Level Railing, order the Level Mid Rail Kits below

MODEL NUMBER	DESCRIPTION
UMX-B1048LKIT-__-1RLS	48" Mid Rail Kit (2 pc) w/ 2 Universal Bottom Brackets & Screws
UMX-B1070LKIT-__-1RLS	72" Mid Rail Kit (2 pc) w/ 2 Universal Bottom Brackets & Screws
UMX-B1097LKIT-__-1RLS	96" Mid Rail Kit (2 pc) w/ 2 Universal Bottom Brackets & Screws

To create a 3-Rail configuration for Horizontal Railing, order the Horizontal Mid Rail Kits below

MODEL NUMBER	DESCRIPTION
UMX-B1048HKIT-__-1RLS	48" Mid Rail Kit (2 pc) w/ 2 Horizontal Bottom Brackets & Screws
UMX-B1070HKIT-__-1RLS	72" Mid Rail Kit (2 pc) w/ 2 Horizontal Bottom Brackets & Screws
UMX-B1097HKIT-__-1RLS	96" Mid Rail Kit (2 pc) w/ 2 Horizontal Bottom Brackets & Screws

To create a 3-Rail configuration for Stairs, order the Stair Mid Rail Kits below

MODEL NUMBER	DESCRIPTION
UMX-B1070VKIT-__-1RLS	72" Mid Rail Kit (2 pc) w/ 2 Vertical Bottom Brackets & Screws
UMX-B1097VKIT-__-1RLS	96" Mid Rail Kit (2 pc) w/ 2 Vertical Bottom Brackets & Screws



37" and 43" Square Baluster 2-Rail Stair Kits

All railing kits feature the Adams Profile and include:

Top and Bottom Rails, Balusters, Stair Hinges and Fasteners which allows adjustments to follow practically any stair angle.

6 ft. kit sections are 70.5" wide; 8 ft. kits are 97.25" wide

A Mid-Rail Kit (UAR-200 3R) is available by special order.

37" Square Baluster 2-Rail Railing Kits

MODEL NUMBER	DESCRIPTION
UMXFS-A200__-3672-2RLS	36" x 72" - 2 Rail Stair Square Kit
UMXFS-A200__-3696-2RLS	36" x 96" - 2 Rail Stair Square Kit

43" Square Baluster 2-Rail Railing Kits

MODEL NUMBER	DESCRIPTION
UMXFS-A200__-4272-2RLS	42" x 72" - 2 Rail Stair Square Kit
UMXFS-A200__-4296-2RLS	42" x 96" - 2 Rail Stair Square Kit

Enter Color Code when ordering: Black: TB / Bronze: TZ / Khaki: TK / White: TW



Top Rail



Bottom Rail

Colors

Ultra Max® Railing, Gates and Accessories are available in four classic textured finish colors. They are all applied with an exclusive Ultra Powercoat™ finish to resist harsh weather and the sun.

Colors shown represent an approximate comparison and may vary slightly from actual product color.

Enter Color Code when ordering:

Black: TB / Bronze: TZ / Khaki: TK / White: TW

Textured Black



Textured Bronze



Textured Khaki



Textured White





2.5" Residential Post Kit

Enter Color Code when ordering: **Black: TB / Bronze: TZ / Khaki: TK / White: TW**

Includes: cap, post, .375" flange, flange cover, and 2 wedges. Fastening hardware NOT included for wood or concrete applications.

MODEL NUMBER	DESCRIPTION	ADDITIONAL
UMXP-25100-38-__	Post 2.5" x 2.5" x 38"	With mount & flange cover
UMXP-25100-44-__	Post 2.5" x 2.5" x 44"	With mount & flange cover
UMXP-25100-54-__	Post 2.5" x 2.5" x 54"	With mount & flange cover

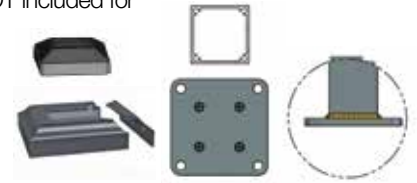

.375" Flange

2.5" Blank Post

Enter Color Code when ordering: **Black: TB / Bronze: TZ / Khaki: TK / White: TW**

MODEL NUMBER	DESCRIPTION	ADDITIONAL
FB-25-100-X-48-__	Post 2.5" x 2.5" x .100 x 48"	With cap only
FB-25-100-X-72-__	Post 2.5" x 2.5" x .100 x 72"	With cap only



3" Commercial Post Kit

Enter Color Code when ordering: **Black: TB / Bronze: TZ / Khaki: TK / White: TW**

Includes: cap, post, .500" flange, flange cover, and 2 wedges. Fastening hardware NOT included for wood or concrete applications.

MODEL NUMBER	DESCRIPTION	ADDITIONAL
UMXP-C6-30125-38-__	Post 3" x 3" x 38"	With mount & flange cover
UMXP-C6-30125-44-__	Post 3" x 3" x 44"	With mount & flange cover
UMXP-C6-30125-54-__	Post 3" x 3" x 54"	With mount & flange cover

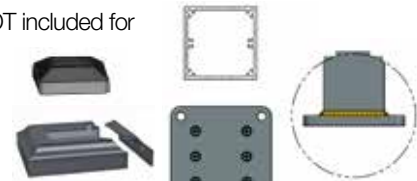

.500" Flange



4" Post Sleeve Enter Color Code when ordering: **Black: TB / Bronze: TZ / Khaki: TK / White: TW**

Cap and Skirt sold separately.

MODEL NUMBER	DESCRIPTION
UMXP-40125-38-__	Post Sleeve 4" x 4" x 38"
UMXP-40125-44-__	Post Sleeve 4" x 4" x 44"
UMXP-40125-54-__	Post Sleeve 4" x 4" x 54"

Caps, Flange Covers and Accessories

Enter Color Code when ordering: **Black: TB / Bronze: TZ / Khaki: TK / White: TW**

MODEL NUMBER	DESCRIPTION	ADDITIONAL
HCP-20-__	2" Cap	1 each
HWC-420-__	2" Flange Cover (skirt)	1 each
HCP-25-__	2.5" Cap	1 each
HWC-525-__	2.5" Flange Cover (skirt)	1 each
HCP-30-__	3" Cap	1 each
HWC-530-__	3" Flange Cover (skirt)	1 each
HCP-40-__	4" Cap	1 each
HWC-400-__	4" Flange Cover (skirt)	1 each
UAR-25-WDG	Wedge Shim for Post	25 pack
UAR-300-WDG	Wedge Shim for Post	300 per case





Column Wrap Enter Color Code when ordering:

Black: TB / Bronze: TZ / Khaki: TK / White: TW

Fastening Hardware NOT included. Use a 6" Wrap for 4x4 wood posts and an 8" Wrap for 6x6 wood posts.

MODEL NUMBER	DESCRIPTION	ADDITIONAL
UARCW-66100-96-__	Column Wrap 6" x 6" x 96"	4 pieces
UARCW-66100-120-__	Column Wrap 6" x 6" x 120"	4 pieces
UARCW-66100-144-__	Column Wrap 6" x 6" x 144"	4 pieces
UARCW-88100-96-__	Column Wrap 8" x 8" x 96"	4 pieces
UARCW-88100-120-__	Column Wrap 8" x 8" x 120"	4 pieces
UARCW-88100-144-__	Column Wrap 8" x 8" x 144"	4 pieces

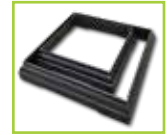

Newel Kits Enter Color Code when ordering

Fastening Hardware NOT included.

MODEL NUMBER	DESCRIPTION	ADDITIONAL
UARN-66100-40-__	Newel Post 6" x 6" x 40"	With Cap, Base and 8 Inserts
UARN-66100-46-__	Newel Post 6" x 6" x 46"	With Cap, Base and 8 Inserts



Column Accessories Enter Color Code when ordering

MODEL NUMBER	DESCRIPTION	ADDITIONAL
CO-8020-550-__	6" Pyramid	1 piece
CO-8030-550-__	6" Classic Newel Cap	2 pieces
CO-8040-__	6" Column Base/Skirt	1 piece
CO-8080-__	8" Column Base/Skirt	1 piece
UARCW-9441-03-__	3" Column Wrap Raised Panel Look	8 pieces
UARCW-9441-04-__	4" Column Wrap Raised Panel Look	8 pieces



Fastening Hardware for Substructure NOT included

Newel Kits - .080" Wall Thickness

(Installed Over Wood) Enter Color Code when ordering:

Black: TB / Bronze: TZ / Khaki: TK / White: TW

MODEL NUMBER	DESCRIPTION
UARN-66100-40-__	Newel Post 6" x 6" x 40" with Cap, Base and 8 Column Lok Inserts
UARN-66100-46-__	Newel Post 6" x 6" x 46" with Cap, Base and 8 Column Lok Inserts

Fastening Hardware NOT included. 3" Column Loks set of 8 Included in NEWEL KIT, create a raised panel. 6" Skirts/Bases are 1 piece.



Fastening Hardware for Substructure NOT included

Newel Kits - Surface Flange Mounted

Enter Color Code when ordering:

Black: TB / Bronze: TZ / Khaki: TK / White: TW

MODEL NUMBER	DESCRIPTION
UARN-66100WKIT-40-__	Newel Post Kit w/Welded Flange .375, 6" x 6" x 40" with Cap, Base and 8 Column Lok Inserts
UARN-66100WKIT-46-__	Newel Post Kit w/Welded Flange .375, 6" x 6" x 46" with Cap, Base and 8 Column Lok Inserts

Fastening Hardware NOT included. 3" Column Loks set of 8 Included in NEWEL KIT, create a raised panel. 6" Skirts/Bases are 1 Piece.



Signature Post To Post Walk Gates

Adams Gate Post Kit - Quick Ship

Enter Color Code when ordering: **Black: TB / Bronze: TZ / Khaki: TK / White: TW**

MODEL NUMBER	DESCRIPTION	ADDITIONAL
UMXGP-A2544KIT-__	2.5" x 44" Posts with Caps	2 pieces
UMXGP-A3044KIT-__	3.0" x 44" Posts with Caps	2 pieces

PURCHASE OF ULTRA MAX LEVEL RAILING KIT IS REQUIRED TO BUILD GATE.

Installation: Determine opening size. Mark and cut top and bottom rails. Drill out the rivet for placement into the gate pocket. Assemble the railing section and lay down. Insert top rail into gate pocket and mark post where the bottom bracket is aligned. Cut the post to 37" and install the bottom brackets where marked using the tek screw.

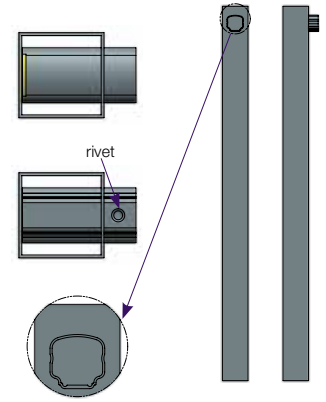

SPECIAL ORDER GATES



37" Adams Post To Post Walk Gates 2.5" Posts

Available in 36", 42" and 48" Widths. **Call for lead times.**

Enter Color Code when ordering: **Black: TB / Bronze: TZ / Khaki: TK / White: TW**

MODEL NUMBER	DESCRIPTION
UARG-A200__-2R-36XX-25	UAR-200 - 2 Rail
UARG-A200__-3R-36XX-25	UAR-200 - 3 Rail
UARG-A220__-3R-36XX-25	UAR-220 - 3 Rail
UARG-A250__-3R-36XX-25	UAR-250 - 3 Rail with Spears
UARG-A270__-3R-36XX-25	UAR-270 - 3 Rail

35" panel height, 2" sweep (hardware sold separately). WALK GATES - Standard-3 5/8" Picket Spacing. Enter length in XX. CHOOSE 36, 42, 48. Also available in 3" Posts.



43" Adams Post To Post Walk Gates 2.5" Posts

Available in 36", 42" and 48" Widths. **Call for lead times.**

Enter Color Code when ordering: **Black: TB / Bronze: TZ / Khaki: TK / White: TW**

MODEL NUMBER	DESCRIPTION
UARG-A200__-2R-42XX-25	UAR-200 - 2 Rail
UARG-A200__-3R-42XX-25	UAR-200 - 3 Rail
UARG-A220__-3R-42XX-25	UAR-220 - 3 Rail
UARG-A250__-3R-42XX-25	UAR-250 - 3 Rail with Spears
UARG-A270__-3R-42XX-25	UAR-270 - 3 Rail

41" panel height, 2" sweep (hardware sold separately). WALK GATES - Standard 3-5/8" Picket Spacing. Enter length in XX. CHOOSE 36, 42, 48. Also available in 3" Posts.

Ultra Max® Level Rail Planning Guide



Cap



Top Rail Bracket



Bottom Rail Bracket



Flange Cover

Ultra Max® Stair Rail Planning Guide

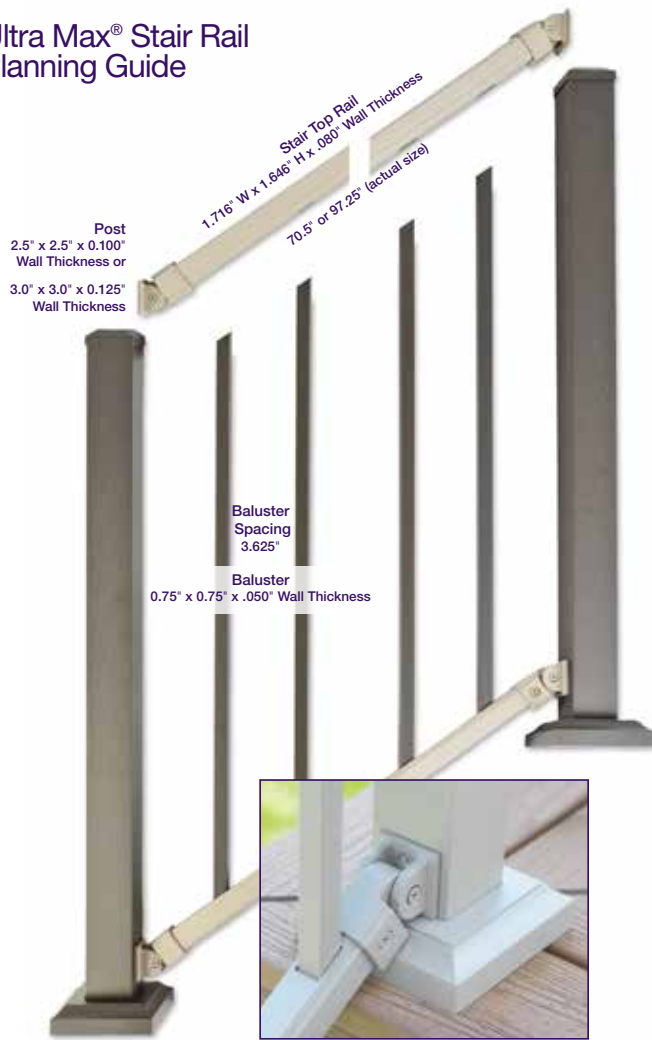

Cap and Top Stair Bracket



Bottom Rail Bracket and Flange Cover



Tools Required: Level, rubber mallet, two speed squares, cordless drill and impact driver, quick clamp grips, measuring tape, miter saw with high tooth count, 13/64" drill bit, #3 screwdriver bit, ratchet set, portable band saw.

IMPORTANT ATTACHMENT NOTE:

It is very important to have proper **BUILDING CODE APPROVED BLOCKING** below deck boards for Building Code Approved attachment and flashing of UMX Post kits.



Layout the deck or patio for optimizing the best use of UMX railing and post kits. Use speed square for placement of the post and squaring flange to structure.

FIREFLY™

illumination by ULTRA

Ultra Firefly™ Railing Illumination makes it simple to light the night alongside your porches, walkways and decks.

New Firefly™ is an integrated low-voltage LED lighting system that is designed to provide a soft glow to your paths from under your Ultra Max railing post caps. We've made it easy to add light and excitement to your new railing system with a complete kit with easy-to-follow installation instructions.

Firefly Kit includes:

- 1 Outdoor DC output transformer w/ Quick Connect lead
- 1 timer/photo cell
- 1 dimmer with remote control
- 1 9' Quick Connect wire
- Dimmer draws 2.5 watts



Uses 1.8 Watts
UARL-LV25KBL



Uses 3.8 Watts
UARL-LV25KDL



Firefly Lighting is 3500K
Which Displays as
"Warm White Light"



Deck Wiring Overview

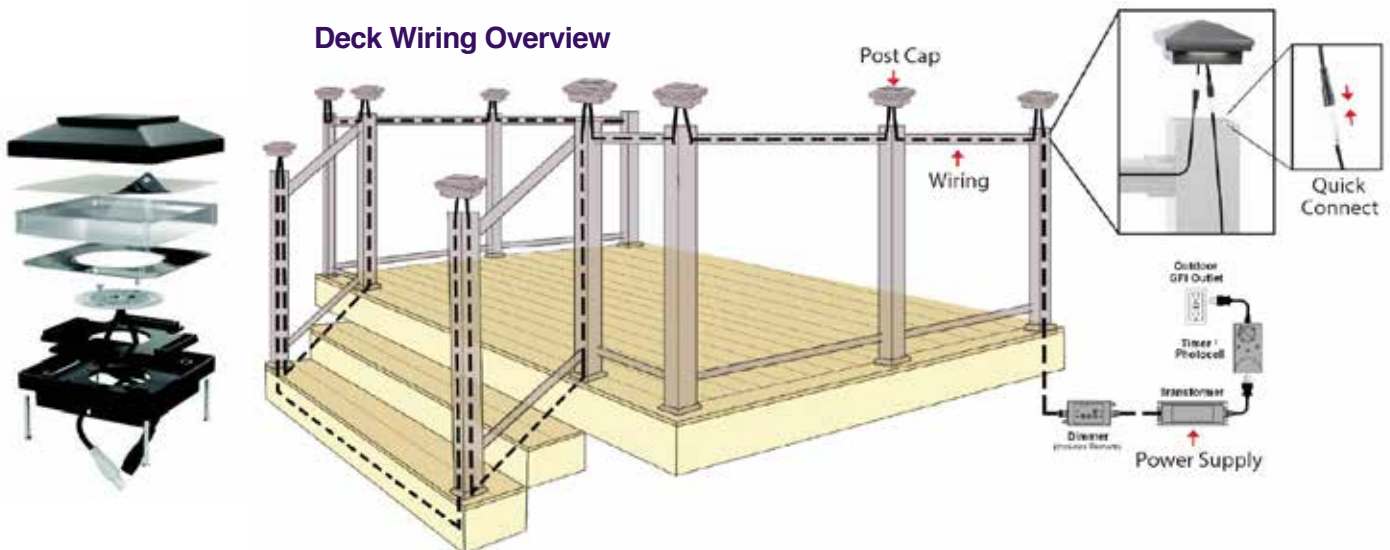

1.5" Secondary Handrail Systems

This system works perfectly with Ultra Signature™ and Ultra Max® Railing

Ultra Signature™ 1.5" secondary handrail is a modular system designed to meet the railing code requirements for the Americans with Disabilities Act and Uniform Federal Accessibility Standards. The advanced mechanical design of the system allows you to assemble the individual parts and kits with no on-site welding. All materials are aluminum and will not rust.

Ultra 1.5" Secondary Handrail System and Accessories

Enter Color Code when ordering: **Black: TB / Bronze: TZ / Khaki: TK / White: TW**

ACC. MODEL NUMBER	DESCRIPTION
UARA-10493-1596-___	1.5" Secondary Rail 96" (8' max length)
UARA-10493-PLKIT - ___	1.5" Secondary Rail P-Loop Kit
UARA-10493-INCK - ___	1.5" Secondary Rail 90° In/Out-Bend Radius
RHG15-JFMKIT-___	1.5" Floor/Wall Mount Kit
RHG15-ILB-TB-___	1.5" Secondary Rail In-Line Bracket w/screws
RHG15-SJKIT-___	1.5" Sec Rail Bracket 2 pc Swivel Kit (2-joiners, 2 rings)
RHG15-JIRKIT-___	1.5" Sec Rail Joiner Insert w/1- ring & screw
RHG15-90KIT-___	1.5" Sec Rail 90° ELBOW w/1-joiner and 1-ring
RHG15-OCBKIT-___	1.5" Sec Rail Outside Corner Kit
RHG15-ICBKIT-___	1.5" Sec Rail Inside Corner Kit

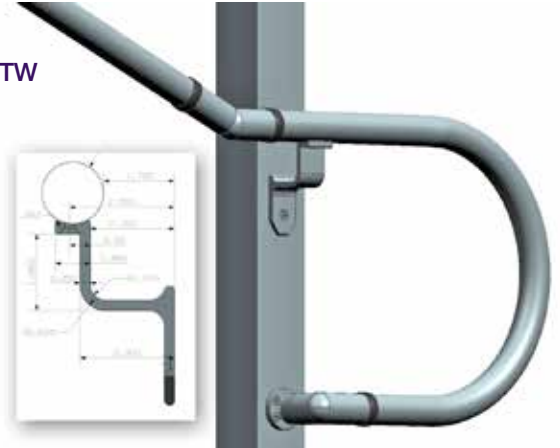

Ultra Aluminum™ has designed our secondary handrail system to blend seamlessly with all our railing designs, offering an extra level of safety, strength and accessibility for any building, deck or porch.

Made with a high-quality powder-coated finish that is AAMA-2604 compliant, our components resist fading, chipping and corrosion. Brackets include fasteners for aluminum post installations. Aluminum rings hide railing seams for a smooth transition between components, and aluminum end caps conceal open rail ends.





Ultra Aluminum™ Lifetime Warranty

Ultra Max™ Aluminum fence and railing products are guaranteed for life against defects in workmanship and/or materials. The exclusive Powercoat™ finish on all railing by Ultra Aluminum™ is unconditionally guaranteed for life against cracking, peeling or chipping. Visit our website for more information and a copy of the warranty.



Environmentally Responsible

Ultra Aluminum™ is proud to use recycled aluminum in our products. Aluminum is the most commonly recycled metal in the world. Our powder coating process is environmentally friendly and virtually pollution-free.

Ultra Aluminum Manufacturing has a quality control system in place and has been qualified as an approved fabricator under the Intertek CCRR evaluation report. Our process minimizes errors in railing production sent to our customers, and ensures the quality of welds, alloys and materials used for our railing systems. Intertek performs quarterly inspections to also ensure the use of their QC controls and logo/marks are maintained and followed.

The Ultra Max™ Railing system utilizes a strong architecturally-pleasing design—the outer rail provides a secure hand grip with a sleek, hidden-fastened look. All railing panels are available in standard 6' and 8' widths. Shorter panels can be provided from the factory, or field trimmed to meet exact measurements on-site.



ULTRARACK ULTRAMAX Defender Signature eclipse Eclipse Collection eclipse.v.p. eclipse air



Manufactured By Ultra Aluminum Mfg., Inc.
www.ultramaxrailing.com | 800.656.4420

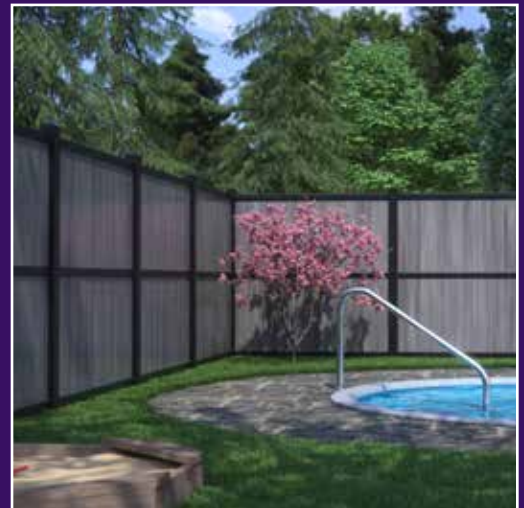

Eclipse VP™ Privacy Fence

Eclipse VP™ privacy screening combines the strength of extruded aluminum posts and caps, and top, middle and bottom rails, with channels to hold rich variegated-color vinyl panel inserts. This system is available in 8' widths with 6' heights.



Ultra Aluminum™ Arbor

Our Ready-To-Build aluminum arbor can be an architecturally appealing, long-lasting addition to your garden or backyard.

Ultra Aluminum™ Low Maintenance Garden Arbors are made in America out of strong aluminum alloys, with advanced powder coating that is twice as hard as typical baked enamel finishes.

- All aluminum components
- Never needs painting
- Won't rust, rot, crack or peel
- Easy to install