



ADAMS GATE KIT INSTALLATION INSTRUCTIONS FOR 2.5" POST UPRIGHTS

- Please read all instructions completely before starting any installation of our pro railing systems.
- Rail sections come in 4ft, 6ft and 8ft.
- Posts are available in RESIDENTIAL rated (2.5" and 3.0") and COMMERCIAL (3" .125 wall with 6 boss channels).
- Ultra Max railings should be installed using accepted building principles in accordance with local building codes and installation guidelines.
- Ultra Max has been tested by Intertek and meets the current testing standards for IRC and IBC construction codes.
- If you have any questions, please call YOUR distributor or check their website for more install details.
- **SAFETY:** Always be safe and follow all instructions when using power tools and always wear safety goggles!
- Any questions? Call 800-656-4420 and ask for your railing specialist.



Intertek
CCRR-0278

TESTED AND EVALUATED



IMPORTANT: Consult your local building code official and check all Code Requirements
IMPORTANT: If installing post lighting, wiring must be installed prior to securing posts.

All fasteners are included in 37" & 43" Ultra Max kits. Fasteners for post base are not included. Ultra Max railing kits (37" & 43") are packaged for secure and safe shipment. Rails and balusters are separated by corrugated compartments. The bracket kit is packaged securely and placed in compartment of the box.

RECOMMENDED TOOLS

- Chop Saw*
- Cordless Drill
- T-30 Driver
- 7/32" Drill Bit
- Square
- Measuring Tape
- Non-Marking Mallet
- Pencil

*Chop saw with an aluminum specific cutting blade

(Use protective work surfaces – cardboard or carpet.
For easier installation, use saw horse work station.)

MATERIALS NEEDED

- Adams Gate Post Kit UMXGP-A2544KIT-XX
- 4ft Ultra Max Level Kit (Sold Separately)
- Gate and Latch Posts (Sold Separately and Previously Installed)
- Post Caps (Sold Separately)
- LokkLatch® Hinge Pair HD-HTM1 (Sold Separately)
- Deluxe Latch HD-LLDSK (Sold Separately)

NOTE:

Discard the Adams 2-Piece Top Rail Brackets as they will not be used.

These instructions ASSUME the use of LokkLatch® HD-HTM1 Hinges and HD-LLDSK Deluxe Latch for proper gate and post spacing. If you are NOT using this hardware purchase from Ultra Aluminum, you must verify hinge and latch gaps with your hardware manufacturer and adjust accordingly.

ADAMS GATE KIT INSTALLATION

- The gate uprights are 42.25" long from the factory, which provides for a 42" high nominal gate. If building 42" nominal height, skip ahead to STEP 3.

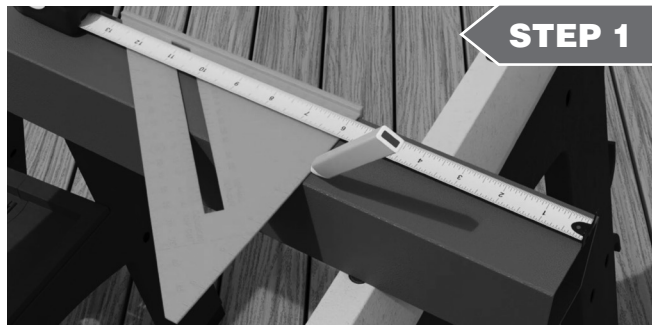

From the bottom of the gate uprights, measure up 6" and place a mark.

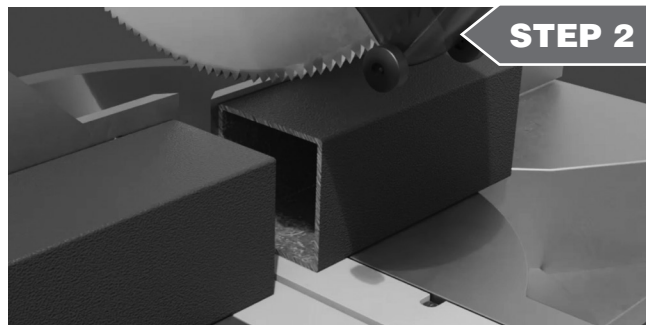

Using a chop saw with an aluminum specific cutting blade, cut the uprights on your mark. You will now have uprights that measure 36.25" to build a 36" high nominal gate.

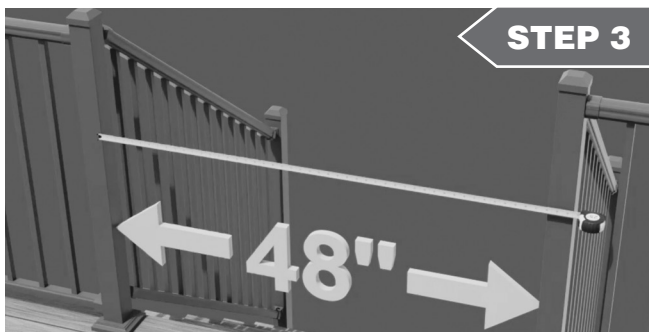

STEP 3

Determine clear opening size where gate will be installed, by measuring between posts. Subtract for the required hinge gap and latch gap as well. Recommended hinge and latch gaps are in your hardware instructions.



STEP 4

When hardware has minimum and maximum gap allowances, we recommend using a measurement in the middle to allow for some plus or minus adjusting. For these instructions, we are using a 48" clear opening for reference.

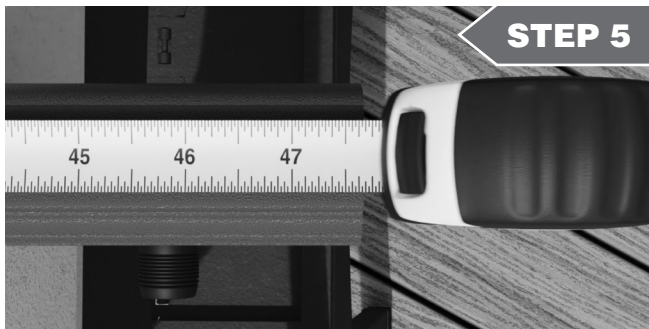

STEP 5

Retrieve the top and bottom rail from the box and confirm factory length of both rails are 47-11/16" and adjust as needed for factory tolerance.

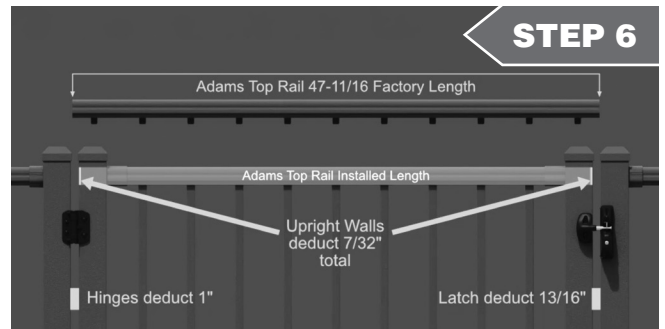

STEP 6

Using a deduction of 7/32" for the inside wall thickness of both gate uprights, 13/16" for the latch and 1" for the hinges (always confirm with your hinge and latch instructions), the overall width of the gate leaf will be 46-7/32".

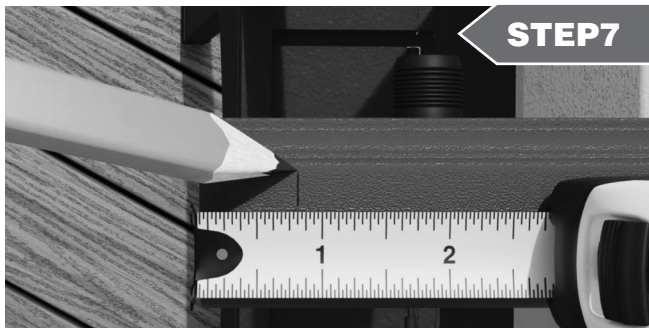

STEP 7

Measure the top rail from each end and place marks 13/16" from the ends. Using the chop saw with an aluminum specific blade, cut the Adams top rail at both ends on your marks.



STEP 8

At both ends of the Adams cut rail, use a 7/32" drill bit to drill out the rivet holding the plastic nub on both ends and discard the (2) plastic nubs.

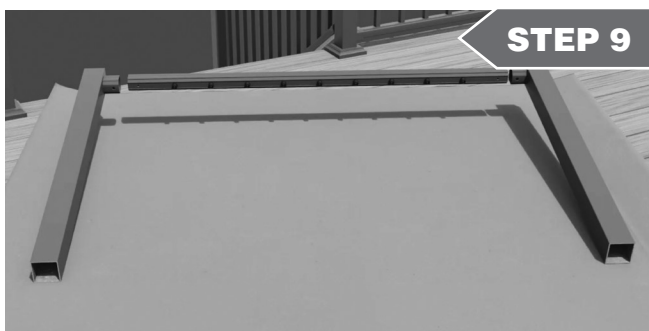

STEP 9

Slide your top rail into the pocket with the nubs facing the ground for both uprights. Ensure the rail is inserted all the way into the upright. Confirm your outside to outside dimensions are 46-7/32".

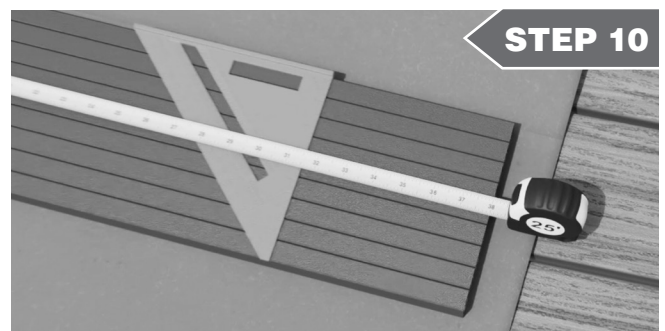

STEP 10

Gather the quantity of pickets needed and mark the required length. If you brought a 43" gate kit, trim the picket length to 36-7/8". If you brought a 37" gate kit, trim the picket length to 30-7/8". Using the chop saw with an aluminum specific cutting blade, cut the pickets on your marks.

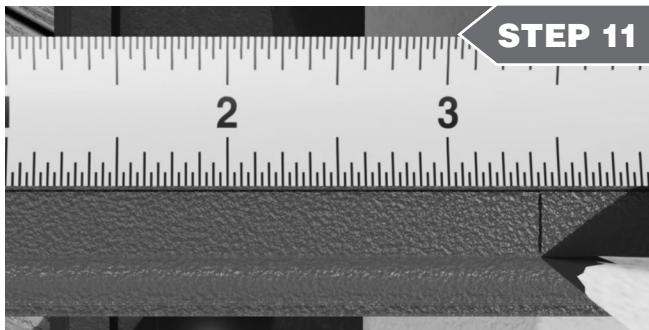

Retrieve bottom rail (factory length of 47-11/16"). Required length of bottom rail is length of top rail minus width of uprights and minus brackets clearance. Total deduction needed is 6-7/8". Measure from both ends of bottom rail and place a mark at 3-7/16" from both ends.

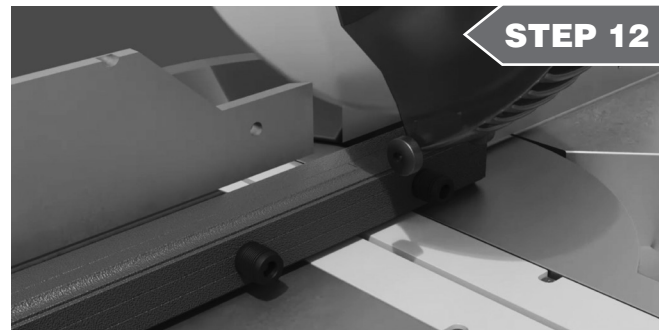

Using the chop saw with an aluminum specific cutting blade, cut the bottom rail at both ends on your marks.

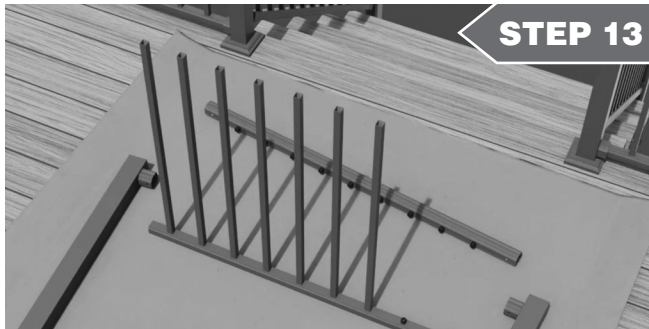

Assemble top and bottom rails with the provided balusters in your kit. You will likely have a few extra balusters. Using light pressure, push balusters over nubs. Slide assembled panel into the upright pockets.

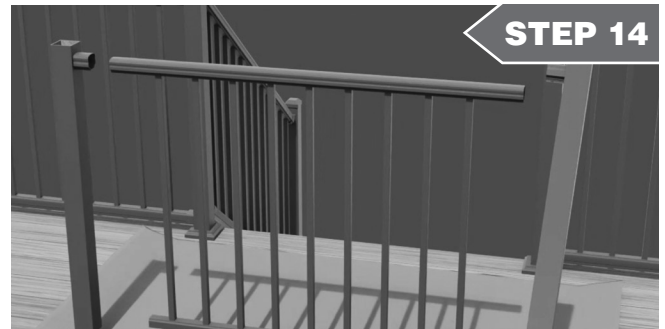

Using light pressure, push balusters over nubs. Slide assembled panel into the upright pockets.

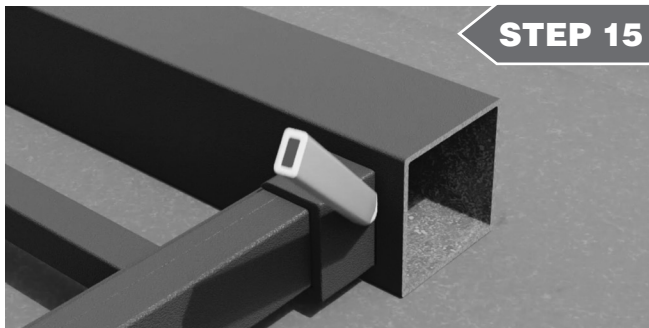

Retrieve one of the bottom brackets and position it as shown. Mark a line along the bottom of the bracket on the upright. Repeat this step on the adjacent upright.

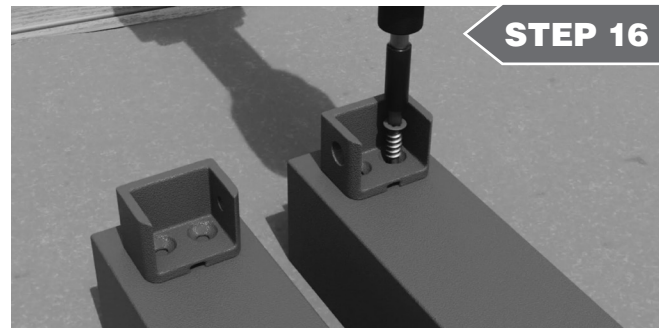

Center the bottom brackets bottom edge to the pencil marks. Then fasten bottom brackets to the uprights with two #14 T-30 x 1" Tek Screws each.

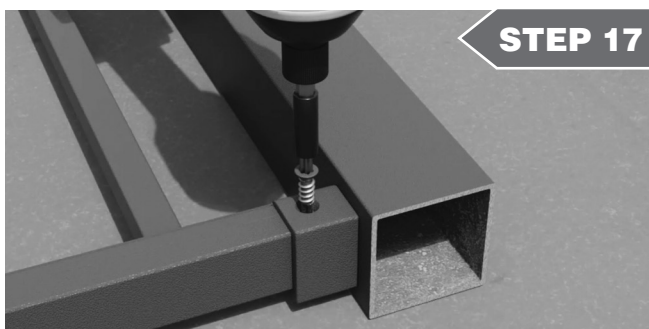

Slide assembled panel into the pockets of gate uprights on both sides and allow bottom rail to slide into the previously installed bottom brackets. Secure the bottom rail with one Tek screw each into both bottom brackets.

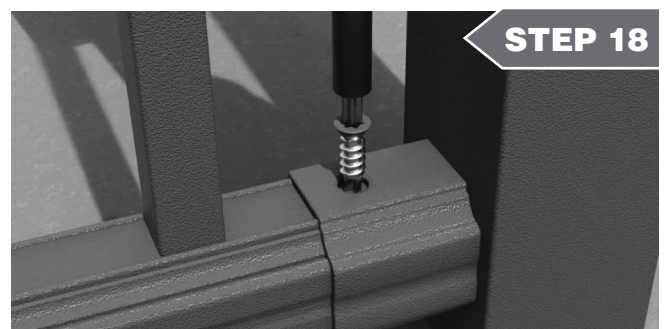

Flip the gate top down on a safe surface and drive one Tek screw each into the undersides of rail pockets where countersunk holes are present on each.

ADAMS GATE KIT INSTALLATION INSTRUCTIONS (continued)

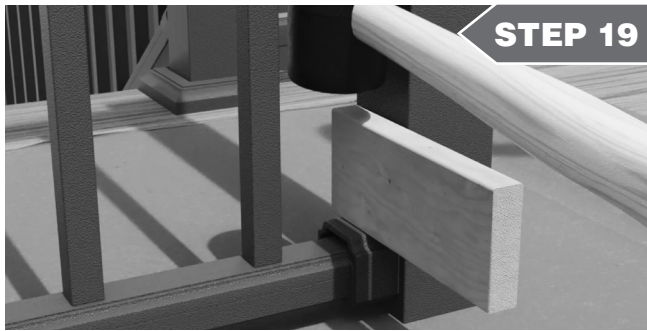

Using a rubber mallet, gently hammer the bottom bracket caps on, ideally with a 3/4" board at the back of the brackets.

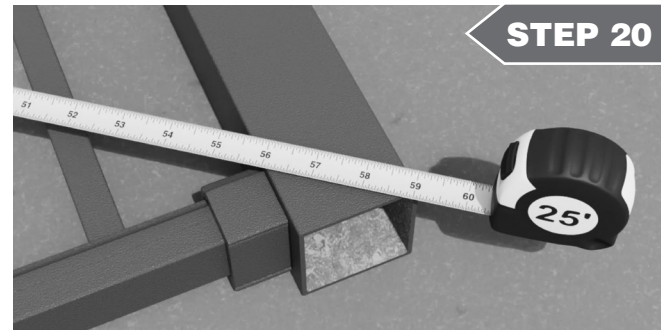

Check that your gate is square by measuring diagonally from corner to corner, confirming that the measurements match.

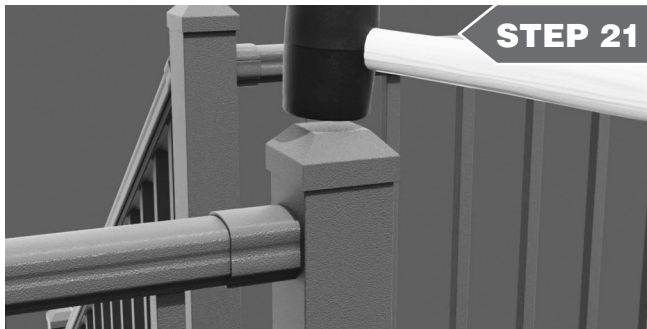

Finalize the gate by tapping post caps on with a rubber mallet.



Mount your finished gate with your hinges and install your latch per the manufacturers install instructions.



ULTRA
FENCING • RAILING

2124 Grand Commerce Drive • Howell, MI 48855

Phone: 517-548-6755 • Fax: 517-548-6756

800-656-4420 | UltraMaxRailing.com

